

# AUSTRA

A MODERN PLATFORM FOR  
MANUFACTURING COMPANIES



# Full product lifecycle support regardless of business location



E-shop



Vendor portal



Seller

Order creation and estimation

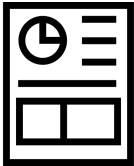

Order processing



Production planning



Logistics planning



Support functionality:

Product configurator

Document generator

Quality management

Salary calculation

Resource planning

Time tracking

Cargo assembly

Assembly planning

- List of raw materials
- Standards of production operations
- Principles of cost calculation

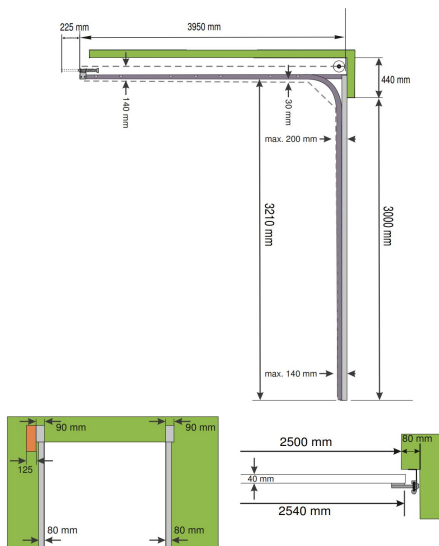

Products / [Insert screen for window / Product component list](#)

Options	Options	Component weight	Component quantity	Component size	Coefficient
14010 horizontal profiles					
AL/PVC profile, anodized	Profile manufacturer: FOSHAN Type of window: AL/PVC Colour: Anodized	0.0045	NB * DIZ / NQ3 * DZ 2	04T11	1.08
AL/PVC profile, anthracite	Profile manufacturer: FOSHAN Colour: Anthracite	0.0045	NB * DIZ / NQ3 * DZ 2	04T11	1.08
AL/PVC profile, brown	Profile manufacturer: FOSHAN Colour: Brown	0.0045	NB * DIZ / NQ3 * DZ 2	04T11	1.08
AL/PVC profile, light brown	Profile manufacturer: FOSHAN Colour: Light brown	0.0045	NB * DIZ / NQ3 * DZ 2	04T11	1.08
AL/PVC profile, raw	Profile manufacturer: FOSHAN Type of window: AL/PVC Colour: Painted	0.0045	NB * DIZ / NQ3 * DZ 2	04T11	1.08
AL/PVC profile, white	Profile manufacturer: FOSHAN Colour: White	0.0045	NB * DIZ / NQ3 * DZ 2	04T11	1.08
Sapa profile, anodized	Colour: Anodized Type of window: Wood	0.0045	NB * DIZ / NQ3 * DZ 2	04T11	1.08
Sapa profile, anthracite	Type of window: Wood Colour: Anthracite	0.0045	NB * DIZ / NQ3 * DZ 2	04T11	1.08
Sapa profile, brown	Colour: Brown Type of window: Wood	0.0045	NB * DIZ / NQ3 * DZ 2	04T11	1.08
Sapa profile, light brown	Colour: Light brown Type of window: Wood	0.0045	NB * DIZ / NQ3 * DZ 2	04T11	1.08
Sapa profile, raw	Colour: Painted Type of window: Wood	0.0045	NB * DIZ / NQ3 * DZ 2	04T11	1.08
Sapa profile, white	Colour: White Type of window: Wood	0.0045	NB * DIZ / NQ3 * DZ 2	04T11	1.08

Options

BOM

Platums	14010 Horizontālie profili				
• Augstums 60	• Nēher Uzkarināmais profils,anodētis E1	Profile manufacturer: FOSHAN	Profile manufacturer: FOSHAN	Colour: Anodized	
• Loga tips 60	• Nēher Uzkarināmais profils,brūns 8016(5m(gab)) B1	Profile manufacturer: FOSHAN	Profile manufacturer: FOSHAN	Colour: Brown	Loga tips AL/PVC
• AL/PVC	• Nēher Uzkarināmais profils,gāli brūns 8001(5m(gab)) B2	Profile manufacturer: FOSHAN	Profile manufacturer: FOSHAN	Colour: Dark brown	Loga tips AL/PVC
• Koka	• Nēher Uzkarināmais profils, anthracē G4	Profile manufacturer: FOSHAN	Profile manufacturer: FOSHAN	Colour: Anthracite	Loga tips AL/PVC
• Izmēra metode 60	• Nēher Uzkarināmais profils,balns 9016(5m(gab)) W1	Profile manufacturer: FOSHAN	Profile manufacturer: FOSHAN	Colour: White	Loga tips AL/PVC
• Ailes (AL, rāmja + Bīrste)	• Nēher Uzkarināmais profils,neapstrādāts (5m(gab)) R1	Profile manufacturer: FOSHAN	Profile manufacturer: FOSHAN	Colour: Raw	Loga tips AL/PVC
• Precīzi AL rāmja bez bīrstes	• Sapa uzkarināmais profils, anodētis	Colour: Anodized	Colour: Anodized		Loga tips Koka
• Bīzurs 60	• Sapa uzkarināmais profils, brūns	Colour: Brown	Colour: Brown		Loga tips Koka
• Rāmja 60	• AL/PVC uzkarināmais profils, balts	Colour: White	Colour: White		Loga tips AL/PVC
• Taisns	• AL/PVC uzkarināmais profils, brūns	Profile manufacturer: FOSHAN	Profile manufacturer: FOSHAN	Colour: Brown	Loga tips AL/PVC
• Slīps	• AL/PVC uzkarināmais profils, Anthracite	Profile manufacturer: FOSHAN	Profile manufacturer: FOSHAN	Colour: Anthracite	Loga tips AL/PVC
• Pielikums 60	• AL/PVC uzkarināmais profils, gāli brūns	Profile manufacturer: FOSHAN	Profile manufacturer: FOSHAN	Colour: Dark brown	Loga tips AL/PVC
• #1 atdurus uz AL profila apakšējās malas	• AL/PVC uzkarināmais profils, Anodizēts	Profile manufacturer: FOSHAN	Profile manufacturer: FOSHAN	Colour: Anodized	Loga tips AL/PVC
• #2 atdurus uz AL profila augšējās malas	• AL/PVC uzkarināmais profils, Neapstrādāts	Profile manufacturer: FOSHAN	Profile manufacturer: FOSHAN	Colour: Raw	Loga tips AL/PVC
• Koka 60	• Sapa uzkarināmais profils, balns	Colour: White	Colour: White		Loga tips Koka
• Bāta	• Sapa uzkarināmais profils, neapstrādāts	Colour: Raw	Colour: Raw		Loga tips Koka
• Gēli brūns	• Sapa uzkarināmais profils, gāli brūns	Colour: Dark brown	Colour: Dark brown		Loga tips Koka
• Brūns	• 14020 Vertikālie profili				
• Anodēts	• Sapa uzkarināmais profils, brūns	Colour: Brown	Colour: Brown		Loga tips Koka
• RAL cta	• Nēher Uzkarināmais profils,anodētis E1	Profile manufacturer: FOSHAN	Profile manufacturer: FOSHAN	Colour: Anodized	Loga tips AL/PVC
• Anthracē	• Nēher Uzkarināmais profils, anthracē G4	Profile manufacturer: FOSHAN	Profile manufacturer: FOSHAN	Colour: Anthracite	Loga tips AL/PVC
• Profila ražotājs 60	• Nēher Uzkarināmais profils,brūns 9016(5m(gab)) W1	Profile manufacturer: FOSHAN	Profile manufacturer: FOSHAN	Colour: White	Loga tips AL/PVC
• Nēher	• Nēher Uzkarināmais profils,brūns 8014(5m(gab)) B1	Profile manufacturer: FOSHAN	Profile manufacturer: FOSHAN	Colour: Brown	Loga tips AL/PVC
• FOSHAN	• Nēher Uzkarināmais profils,gāli brūns 8001(5m(gab)) B2	Profile manufacturer: FOSHAN	Profile manufacturer: FOSHAN	Colour: Dark brown	Loga tips AL/PVC
• RAL 60	• Nēher Uzkarināmais profils,neapstrādāts (5m(gab)) R1	Profile manufacturer: FOSHAN	Profile manufacturer: FOSHAN	Colour: Raw	Loga tips AL/PVC



# Order creation, estimation and circulation



E-shop



Vendor portal



Seller



Structured  
order  
information  
from the source

## Automatic generation of full order information:

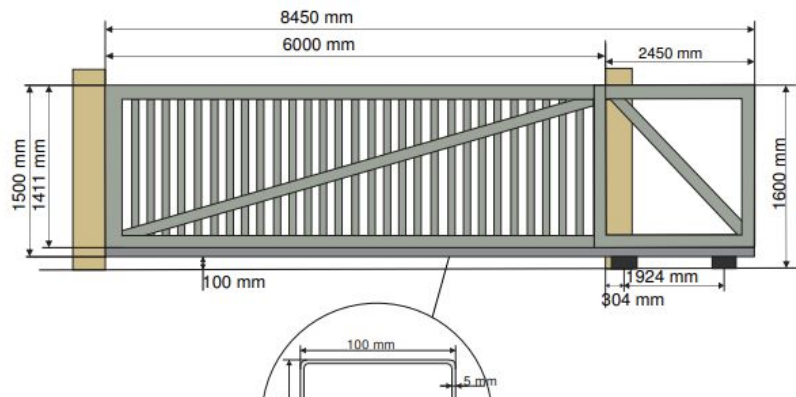

Product	Sk.	Apzīmējums	Parametri	Normējums	Cena (bez PVN)
1. Sekoju vārti	12	Vārtu tips Industriālie	W - Platums 4500 H - Augstums 1700	H - Vieta virs ailes 1700 Pacēlums Sīpats standarts	Slīdes Industriālais 2mm 12 x 6:38:32 29,007.14
2. Sekoju vārti	32	Vārtu tips Industriālie	W - Platums 4500 H - Augstums 5000	H - Vieta virs ailes 1700 Pacēlums Sīpats standarts	Slīdes Industriālais 2mm 32 x 3:36:51 62,162.73
3. Paceltāja/stalžu/mehānismu īre/montāža	16	Tornis / paceltājs Paceltāja īre ar piegādi 85			16 x 0:00:00 1,360.00
4. Elektriskais aizsērējs 12V DC (sprūde)	12				12 x 0:00:30 110.04

### Nomenklatūra

Punkts	Ražotāja artikuls	H.kods	Nosaukums	Atlikums	Rezervēts	Detalju...	Sagat...	Detaljas izm.	Cena
00100 Paneļi	Ceļa darbs	CED1	Izgatavošana			1413.73	1413.73	32.14	
00100 Paneļi	TE 625x4576 RI SILVER	TEP625X4576S	Vārtu paneļi TE 625x4576 RI SIL...	1.3	0	352	352	4536	
00200 Paneļu gaili	Ceļa darbs	CED1	Izgatavošana			704	704	16	
00200 Paneļu gaili	PG625INDL	BB021-3L	Paneļu gaili PG625INDL	594	115	352	352	0	
00200 Paneļu gaili	PG625INDR	BB021-3R	Paneļu gaili PG625INDR	594	115	352	352	0	
00300 Blīvgumijas Profils	1038-5100	FF1038-5100	Blīvgumijas profils 1038-5100	110	10.5	44	44	4540	

- Product type
- Product dimensions and other attributes
- Product options
- Delivery method

- Product documentation (estimate, offer, etc.)
- Production specification
- Assembly instructions
- Standards of production operations

### Jauns

Enormous Wool Table	Elizabete Vanags 56-9315
Ergonomic Bronze Lamp	Ansis Tiruma 39-3316
Synergistic Steel Clock	Laura Barulis 22-3211
Durable Leather Shirt	Antra Krūmiņa 42-5133

### Līgums noslēgts

Incredible Iron Table	Ainars Matīss 51-5712
Durable Paper Pants	Kristīne Ozola 44-3198
Enormous Concrete Lamp	Johans Tiruma 20-7624
Small Leather Car	Maira Dukurs 67-2319

### Nodots ražošanai

Incredible Plastic Bench	Ausma Eglītis 42-9299
Synergistic Concrete Bottle	Juris Ābols 59-1130
Mediocre Iron Lamp	Ingus Jansons 91-514
Fantastic Wooden	

### Noliktavā

Aerodynamic Linen Bottle	Brojislava Bērziņa 68-1572
Sleek Plastic Wallet	Alekss Baumanis 40-2734
Fantastic Granite Lamp	Mediocre Iron Lamp 44-7327
Synergistic Concrete Bench	Lolita Vilks 23-8375

### Montāžā

Aerodynamic Wool Coat	Niks Alksnis 99-2190
Gorgeous Bronze Knife	Elita Novickis 74-7018
Rustic Plastic Car	Gunita Gulbis 58-9653
Mediocre Linen Shirt	Andrejs Zariņš 80-9415

### Atcelts

Durable Bronze Bench	Džeimss Vitoliņš 69-9655
Awesome Iron Table	Agnis Mucenieks 60-3435
Awesome Concrete Wallet	Haris Ullmanis 52-2046
Awesome Iron Knife	Austris Medvedevs 47-3706



Upload and interpretation of CAD models

Tekla | Revit | SolidWorks | SketchUp | etc..



Production standards

07.04.2020	
Kopā	76.34
Bez grupas	66.00 0.00
Preču izsniegšana	2.00 9.25
Noliktava	7.00 2.31
Paneļu cehs	14.00 3.54
Dzeļu cehs	10.00 5.33
AL cehs	28.00 11.15
Metinātava	14.00 42.14
Krāsošana	0.00 0.61

BOM / Raw materials

Kopīgais saraksts		Pa izstrādājumiem								
Punkts	Ražotāja artikuls	H.kods	Nosaukums	Atlikums	Rezervēts	Detalju...	Sagat...	Detaljas izm.	Cena	
00100	Paneli	Ceha darbs	CED1	Izgatavošana		1413.73	1413.73	32.14		
00100	Paneli	TE 625x4576 RI SILVER	TER625X4576S	Viršu paneli TE 625x4576 RI Sl...	1.3	352	352	4536		
00200	Paneļu gals	Ceha darbs	CED1	Izgatavošana		704	704	16		
00200	Paneļu gals	PG625INDL	BB021-3L	Paneļu gals PG625INDL	594	352	352	0		
00200	Paneļu gals	PG625INDR	BB021-3R	Paneļu gals PG625INDR	594	352	352	0		
00300	Blīvgumijas Profis	1038-5100	FF1038-5100	Blīvgumijas profis 1038-5100	110	44	44	4540		
00300	Blīvgumijas Profis	Ceha darbs	CED1	Izgatavošana		114	114	1.5		
00301	Blīvg. profiļi personāli durvīm	1041LTB5050	FF1041LTB5050	Blīvgumijas profiļi 1041LTB5050	17.5	12	12	4540		
00301	Blīvg. profiļi personāli durvīm	Ceha darbs	CED1	Izgatavošana		540	540	45		
00301	Blīvg. profiļi personāli durvīm	1041U3050	FF1041U3050	Zemā sliekšņa U profiļi 1041US...	33.52	0	24	14.77	1870	
00302	Apakšējā blīvgumija	Ceha darbs	CED1	Izgatavošana		84	84	3		
00302	Apakšējā blīvgumija	1035L	FF1035L	Zemā sliekšņa blīvgumija 1035L	191.44	0	24	111.13	4540	
00303	Augšējā blīvgumija	1036-36	FF1036-36	Augšas blīvgumija 1036-36	1416.8	93.06	44	203.72	4540	400.85

Material optimization

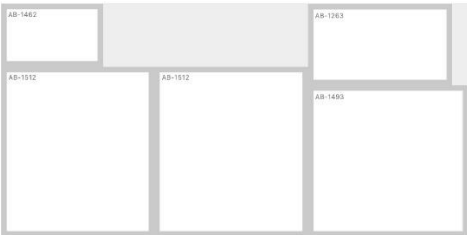

## Standardized and transparent information flow and automated processes

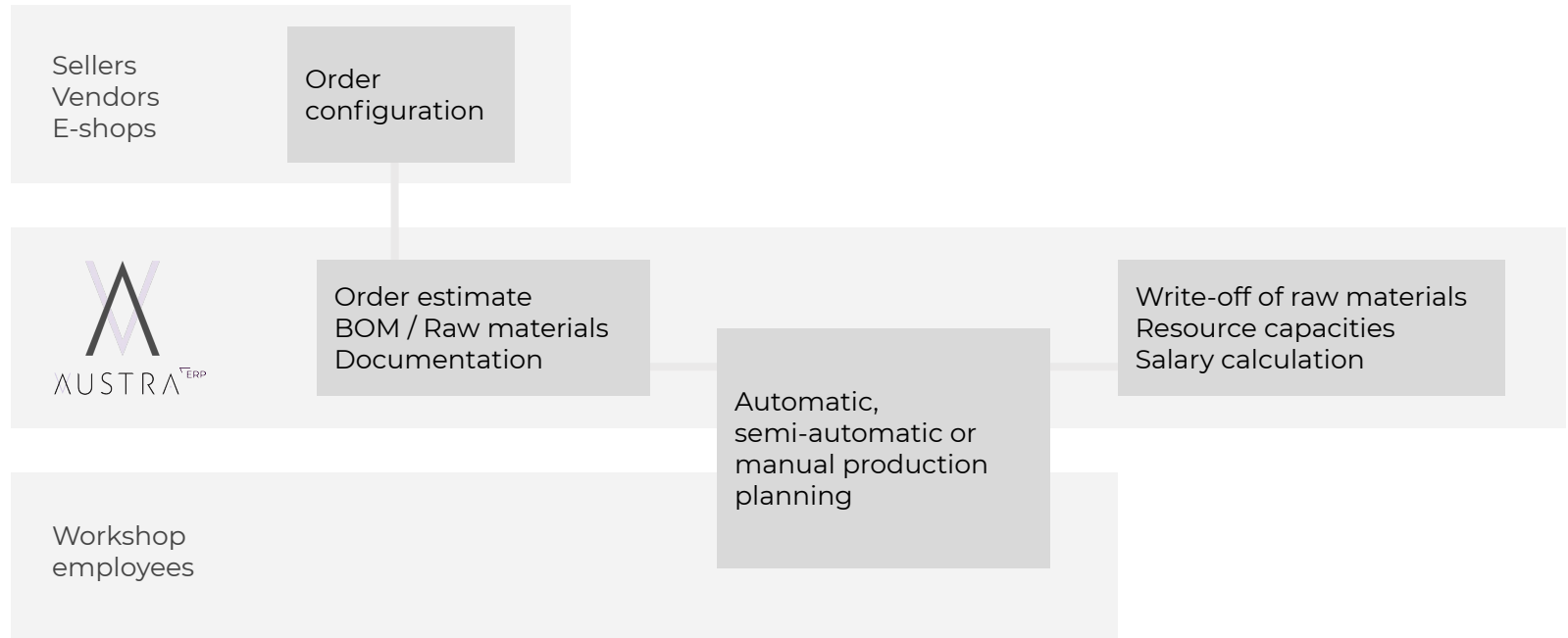



## Transparent and intuitive production planning

- Drag-and-drop: Convenient plan creation and change management
- Calendar view: Overview of the overall production plan
- Operational Capacities: Transparent resource utilization and analytics
- Convenient navigation to related interfaces: Order specification, documentation, etc.
- Information filtering options: Equipment, employees, orders, product types

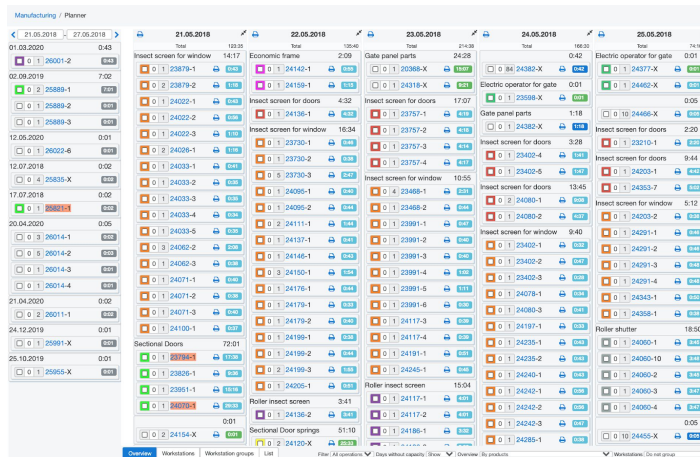

Operations			Order items			Product groups		
<input type="button" value="Cancelled"/> <input type="button" value="New"/> <input type="button" value="Produced"/> <input type="button" value="Checked"/> <input type="button" value="Writeoff in progress"/> <input type="button" value="Writeoff completed"/>			<input type="button" value="Cancelled"/> <input type="button" value="In production"/> <input type="button" value="Stored"/> <input type="button" value="In assembly"/> <input type="button" value="Completed"/>			<input type="button" value="Doors and Gates"/> <input type="button" value="Insect screen"/>		
Order#	Representative		Ordered by			Planned date		
0 1 22598-1	EBR	0:00	BÜVUZŅĒMUMS RESTAURATORS, AS			28.05.2018		
0 1 22598-2	EBR	0:00	BÜVUZŅĒMUMS RESTAURATORS, AS			28.05.2018		
0 1 22598-3	EBR	0:00	BÜVUZŅĒMUMS RESTAURATORS, AS			28.05.2018		
0 1 22598-4	EBR	1:11	BÜVUZŅĒMUMS RESTAURATORS, AS			28.05.2018		
0 1 22598-5	EBR	1:11	BÜVUZŅĒMUMS RESTAURATORS, AS			28.05.2018		
0 1 22598-6	EBR	0:00	BÜVUZŅĒMUMS RESTAURATORS, AS			28.05.2018		
0 1 22598-7	EBR	0:00	BÜVUZŅĒMUMS RESTAURATORS, AS			28.05.2018		
0 1 22598-8	EBR	0:00	BÜVUZŅĒMUMS RESTAURATORS, AS			28.05.2018		
0 7 22599-1	EBR	0:02	BÜVUZŅĒMUMS RESTAURATORS, AS			30.05.2018		
0 2 23141-1	UHO	7:04	Aimasa, SIA			30.05.2018		
0 1 23141-2	UHO	0:03	Aimasa, SIA			30.05.2018		

28.05.2018		
Total	117:29	
Without group	56:00	0:00
Packing workstation	1:00	2:52
Storage workstation	4:00	2:13
Panel workstation	8:00	15:36
Metal workstation	24:00	15:40
Aluminium workstation	16:00	52:25
Welding workstation	24:00	13:46
Painting workstation	0:00	15:00

28.05.2018		
Total	117:29	
Without group	56:00	0:00
Packing workstation	1:00	2:52
Storage workstation	4:00	2:13
Panel workstation	8:00	15:36
0 1 23446-1		1:53
0 1 23791-1		1:25
0 1 23845-1		1:49
0 1 24147-1		4:19

## Planning algorithms based on order parameters and resource capacities

Order parameters
Order configuration and confirmation
List of order raw materials
Order workload norms
Delivery terms
Order priorities
Resource parameters
Equipment capacity
Human resource capacity
Availability of raw materials in stock

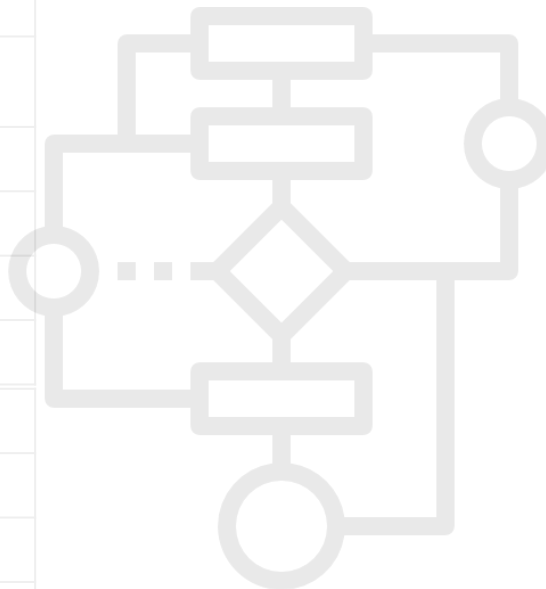

### Automatically generated production plan

Manufacturing / Planner

21.05.2018	22.05.2018	23.05.2018	24.05.2018
<p>01.03.2020 0:43</p> <p>0 1 26001-2 0:43</p> <p>02.09.2019 7:02</p> <p>0 2 25889-1 7:02</p> <p>0 1 25889-2 0:01</p> <p>0 1 25889-3 0:01</p> <p>12.05.2020 0:01</p> <p>0 1 26022-6 0:01</p> <p>12.07.2018 0:02</p> <p>0 4 25635-X 0:02</p> <p>17.07.2018 0:02</p> <p>0 1 25635-X 0:02</p> <p>20.04.2020 0:05</p> <p>0 3 26014-1 0:05</p> <p>0 5 26014-2 0:05</p> <p>0 1 26014-3 0:05</p> <p>0 1 26014-4 0:05</p> <p>21.04.2020 0:02</p> <p>0 2 26011-1 0:02</p> <p>24.12.2019 0:01</p> <p>0 1 25991-X 0:01</p> <p>25.10.2019 0:01</p> <p>0 1 25995-X 0:01</p>	<p>14:17</p> <p>0 1 23879-1 14:17</p> <p>0 2 23879-2 14:17</p> <p>0 1 24022-1 14:17</p> <p>0 1 24022-2 14:17</p> <p>0 1 24022-3 14:17</p> <p>0 2 24026-1 14:17</p> <p>0 1 24033-1 14:17</p> <p>0 1 24033-2 14:17</p> <p>0 1 24033-3 14:17</p> <p>0 1 24033-4 14:17</p> <p>0 1 24033-5 14:17</p> <p>0 3 24062-2 14:17</p> <p>0 1 24062-3 14:17</p> <p>0 1 24071-1 14:17</p> <p>0 1 24071-2 14:17</p> <p>0 1 24071-3 14:17</p> <p>0 1 24100-1 14:17</p> <p>Sectional Doors 72:01</p> <p>0 1 23944-X 72:01</p> <p>0 1 23826-1 72:01</p> <p>0 1 23951-1 72:01</p> <p>0 1 24075-X 72:01</p> <p>0 2 24154-X 72:01</p>	<p>2:09</p> <p>0 1 24142-1 2:09</p> <p>0 1 24159-1 2:09</p> <p>0 1 24136-1 2:09</p> <p>0 1 23730-1 2:09</p> <p>0 1 23730-2 2:09</p> <p>0 5 23730-3 2:09</p> <p>0 1 24095-1 2:09</p> <p>0 1 24095-2 2:09</p> <p>0 2 24111-1 2:09</p> <p>0 1 24137-1 2:09</p> <p>0 1 24146-1 2:09</p> <p>0 3 24150-1 2:09</p> <p>0 1 24176-1 2:09</p> <p>0 1 24179-1 2:09</p> <p>0 1 24179-2 2:09</p> <p>0 1 24199-1 2:09</p> <p>0 1 24199-2 2:09</p> <p>0 1 24199-3 2:09</p> <p>0 1 24205-1 2:09</p> <p>0 1 24136-2 2:09</p> <p>0 1 24117-2 2:09</p> <p>0 1 24186-1 2:09</p> <p>0 2 24120-X 2:09</p>	<p>24:28</p> <p>0 1 20368-X 24:28</p> <p>0 1 24319-X 24:28</p> <p>0 1 23757-1 24:28</p> <p>0 1 23757-2 24:28</p> <p>0 1 23757-3 24:28</p> <p>0 1 23757-4 24:28</p> <p>0 4 23488-1 24:28</p> <p>0 1 23488-2 24:28</p> <p>0 1 23991-1 24:28</p> <p>0 1 23991-2 24:28</p> <p>0 1 23991-3 24:28</p> <p>0 1 23991-4 24:28</p> <p>0 1 23991-5 24:28</p> <p>0 1 24117-3 24:28</p> <p>0 1 24117-4 24:28</p> <p>0 1 24191-1 24:28</p> <p>0 1 24245-1 24:28</p> <p>0 1 24205-1 24:28</p> <p>0 1 24117-1 24:28</p> <p>0 1 24117-2 24:28</p> <p>0 1 24186-1 24:28</p> <p>0 1 24285-1 24:28</p>

Filter / All components | Days without capacity | Show | Overview / By products



# Configurable logistics management process

- ➔ Packing-list creation based on volume and /or weight capacity
- ➔ Route, cargo, transport planning
- ➔ Internal and outsourced logistics planning and information flows
- ➔ Cargo optimization and automation options
- ➔ Automated documentation generation

Loģistika / Paku plānotājs

Neieplānotie

00032-6 W 50 PR S1/1000 6000

00032-5 W 50 PR S1/1000 6000

00032-4 W 50 PR S1/1000 6000

Pievienot

Autom. plānošana

Pasūtījuma nr.

00038/8

W 200 MW T2/1000 6250

6250x1000x1200

1002\*1002 | V0/V0 | PE/PE | 0.5/0.5

00038-2

W 200 MW T2/1000 6250

00038-2

W 200 MW T2/1000 6250

00038-2

W 200 MW T2/1000 6250

00038-2

W 200 MW T2/1000 6250

00038-2

W 200 MW T2/1000 6250

00038-2

W 200 MW T2/1000 6250

00038/5

W 200 MW T2/1000 6250

6250x1000x1200

1002\*1002 | V0/V0 | PE/PE | 0.5/0.5

00038-2

W 200 MW T2/1000 6250

00038-2

W 200 MW T2/1000 6250

00038-2

W 200 MW T2/1000 6250

00038-2

W 200 MW T2/1000 6250

00038-2

W 200 MW T2/1000 6250

00038-2

W 200 MW T2/1000 6250

00038/2

W 150 MW T2/1000 7000

7000x1000x1200

1002\*1002 | V0/V0 | PE/PE | 0.5/0.5

00038/7

W 200 MW T2/1000 6250

6250x1000x1200

1002\*1002 | V0/V0 | PE/PE | 0.5/0.5

00038-2

W 200 MW T2/1000 6250

00038-2

W 200 MW T2/1000 6250

00038-2

W 200 MW T2/1000 6250

00038-2

W 200 MW T2/1000 6250

00038-2

W 200 MW T2/1000 6250

00038-2

W 200 MW T2/1000 6250

00038/4

W 200 MW T2/1000 6250

6250x1000x1200

1002\*1002 | V0/V0 | PE/PE | 0.5/0.5

00038-2

W 200 MW T2/1000 6250

00038-2

W 200 MW T2/1000 6250

00038-2

W 200 MW T2/1000 6250

00038-2

W 200 MW T2/1000 6250

00038-2

W 200 MW T2/1000 6250

00038-2

W 200 MW T2/1000 6250

00038/1

W 150 MW T2/1000 7000

7000x1000x1200

1002\*1002 | V0/V0 | PE/PE | 0.5/0.5

00038/6

W 200 MW T2/1000 6250

6250x1000x1200

1002\*1002 | V0/V0 | PE/PE | 0.5/0.5

00038-2

W 200 MW T2/1000 6250

00038-2

W 200 MW T2/1000 6250

00038-2

W 200 MW T2/1000 6250

00038-2

W 200 MW T2/1000 6250

00038-2

W 200 MW T2/1000 6250

00038-2

W 200 MW T2/1000 6250

00038/3

W 150 MW T2/1000 7000

7000x1000x600

1002\*1002 | V0/V0 | PE/PE | 0.5/0.5

00038-1

W 150 MW T2/1000 7000

00038-1

W 150 MW T2/1000 7000

00038-1

W 150 MW T2/1000 7000

00038-1

W 150 MW T2/1000 7000

00038-1

W 150 MW T2/1000 7000

00038/3

W 120 MW T2/1000 6000

6000x1000x120

1002\*1002 | V0/V0 | PE/PE | 0.5/0.5

Loģistika / Piegādes

Mainīt statusu

Meklēt papildināti/iestatījumi

Numurs

Plānots iekraut

Plānots piegādāt

Klients

Ataist

Atcelt

Aktuālie

Visi

Piegāde	Numurs	Klients	Uzkraušanas adrese	Izkraušanas adrese	Plānots iekraut	Plānots izkraut	Pārvadātājs	Apraksts	Laukums	Svars	Piegādes valsts	Piegādes pilsēta
00038	00038-1		Lauku iela 23, Dobeles novads, Latvija, LV-3701	Rūpniecības iela 13, Aizkraukle, Latvija	28.05.2020 10:00	29.05.2020 16:30	Shenker		56.0	3456.0	Latvija	Aizkraukle
2020-04-29	2020-04-29-1		Lauku iela 23, Dobeles novads, Latvija, LV-3701	Jelgavas iela 7, Bērziņciems, Tukums, Latvija, LV-9999					12.0	864.0	Latvija	Tukums
00031/6	00031/6-1		Lauku iela 23, Dobeles novads, Latvija, LV-3701	Jelgavas iela 7, Bērziņciems, Tukums, Latvija, LV-9999		21.04.2020 20:00			6.0	432.0	Latvija	Tukums
00031/5	00031/5-1		Lauku iela 23, Dobeles novads, Latvija, LV-3701	Jelgavas iela 7, Bērziņciems, Tukums, Latvija, LV-9999		21.04.2020 20:00			6.0	432.0	Latvija	Tukums
00031/4	00031/4-1		Lauku iela 23, Dobeles novads, Latvija, LV-3701	Jelgavas iela 7, Bērziņciems, Tukums, Latvija, LV-9999		21.04.2020 20:00			6.0	432.0	Latvija	Tukums
00031/3	00031/3-1		Lauku iela 23, Dobeles novads, Latvija, LV-3701	Jelgavas iela 7, Bērziņciems, Tukums, Latvija, LV-9999		21.04.2020 20:00			6.0	432.0	Latvija	Tukums
00031/2	00031/2-1		Lauku iela 23, Dobeles novads, Latvija, LV-3701	Jelgavas iela 7, Bērziņciems, Tukums, Latvija, LV-9999		21.04.2020 20:00			6.0	432.0	Latvija	Tukums

# Assembly resource planning

- Creation of assembly orders
- Establishment and planning of assembly brigade
- Assembly team worker capacities
- Grouping of assembly tasks by products, assembly orders, etc.
- Employee logistics planning
- Creation to-do tasks

Montāža / Plānotājs  
27.04.2020 - 03.05.2020

27.04

Māris, MārtiņšM  
LC-893  
0 1 33395-1 8.24  
10.06 0 1 34811-1 12.48  
30.09 0 6 36328-1 63.27  
0 1 36328-2 12.00  
0 4 36328-4 44.24  
0 1 36328-5 7.00  
0 1 36328-6 10.36  
0 3 36328-7 33.36  
11.10 0 1 39450-1 8.24  
06.01 0 1 41863-1 13.16  
20.01 0 1 42319-5 7.20  
24.01 0 1 40819-13 105.00  
29.01 0 1 32754-1 10.00  
08.03 0 1 35598-2 0.30  
08.04 0 1 44371-1 8.30  
15.04 0 1 29172-8 10.00  
24.04 0 1 45482-1 7.36  
27.04 0 1 46609-1 3.00  
29.04 0 1 46132-1 0.45  
30.04 0 2 46558-1 1.12  
0 2 46558-2 1.12

27.04

Māris, MārtiņšM  
LC-893  
0 2 45565-1 6.03  
0 1 45989-1 0.45  
0 2 46112-1 0.54  
0 1 46112-2 0.27  
0 1 46112-3 0.27  
0 1 46499-1 1.00  
AndrisK, AndrisR  
KJ 1759  
0 1 45399-1 12.48  
0 1 46540-2 2.27  
0 1 46663-1 8.00  
Armands, EIM  
KD 1718  
0 1 46593-2 2.00  
0 1 46609-1 1.00  
0 1 46650-1 1.00  
Gints  
KS 6574  
0 1 46604-3 1.00  
0 1 45368-1 10.36  
JST, JānisV  
KJ 4583  
0 1 46569-2 4.00  
Armands  
KD 1718  
0 1 46838-2 0.30

28.04

AndrisK, AndrisR, Armands...  
KJ 1759  
0 1 42987-2 21.00  
0 1 42987-5 4.00  
Māris, MārtiņšM  
LC-893  
0 1 44727-1 8.00  
0 1 46519-6 2.00  
0 1 46611-4 3.00  
JST, JānisV  
KJ 4583  
0 1 45555-1 12.24  
0 1 45555-2 4.00  
Māris, MārtiņšM  
LC-893  
0 1 46714-1 1.00

29.04

AndrisK, AndrisR  
KJ 1759  
0 1 45444-1 7.24  
0 1 46768-3 4.00  
0 1 46779-1 2.00  
JST, JānisV  
KJ 4583  
0 1 45243-1 5.06  
0 1 45243-2 5.00  
Māris, MārtiņšM  
LC-893  
0 1 43184-25 3.06  
0 1 45713-1 8.00  
0 1 46467-12 0.45  
0 1 46467-14 1.00  
Gints  
KS 6574  
0 1 46708-2 1.00  
0 3 46715-1 3.00  
Armands, EIM  
KD 1718  
0 1 46772-4 1.00  
0 3 46772-5 3.00  
0 2 46772-6 2.00

30.04

AndrisK, AndrisR, Armands  
KJ 1759  
0 1 43310-1 15.48  
0 1 43310-2 15.48  
JST, JānisV  
KJ 4583  
0 1 45822-1 4.00  
Māris, MārtiņšM  
LC-893  
0 2 45576-1 8.00  
0 1 45576-2 3.00  
0 1 46350-1 5.16  
0 1 46760-1 1.00  
EIM  
MF 8445  
0 1 46398-4 2.00  
Armands, EIM, Gints  
KS 6574  
0 1 46891-1 36.00

Labot braucienu

Montāžas datums 27.04.2020

Darbinieki

Auto / Šoferis KD 171

Plānotais attālums (km) / Laiks ceļā 30 km 0 HH 40 MM

Piezīmes

Pasūtītāja 46838 darba piezīmes: -

46838-2

Saglabāt

Atceļt

## Accelerated information flow

- Maintaining product life-cycle status
- Employee time tracking
- Notification of system events
- Quality management: photo and video capture
- GPS coordinates

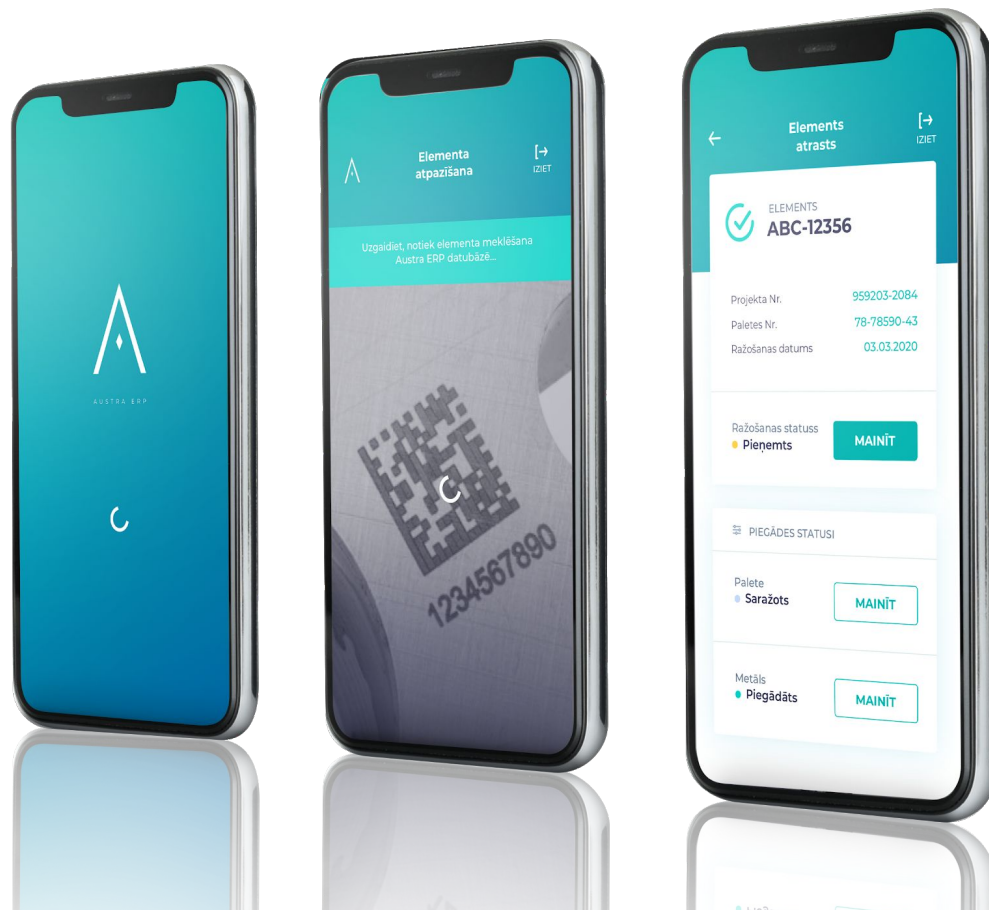



# Automated data flows and various module configuration options

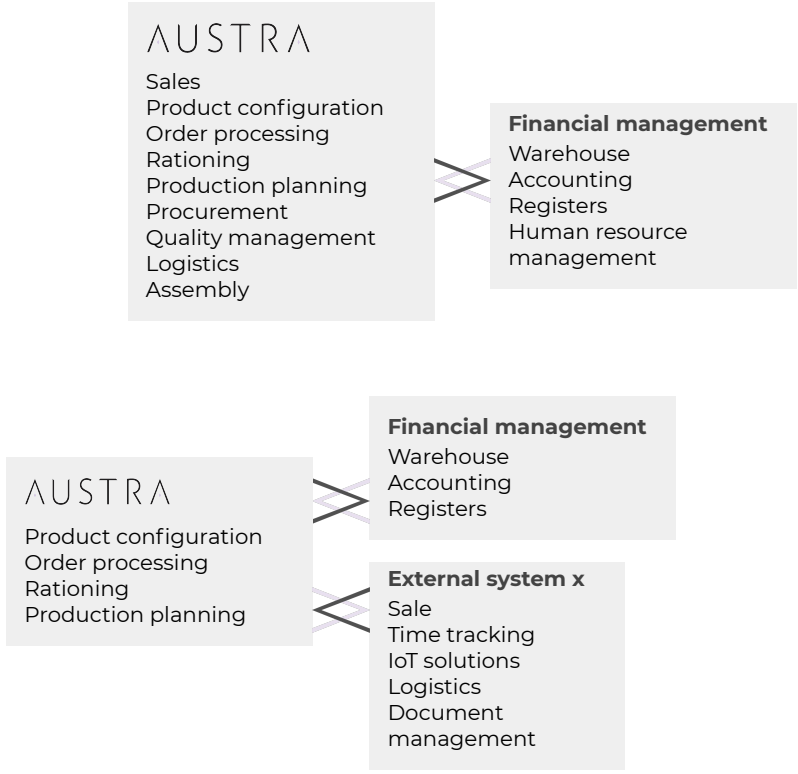

## **Contact us for Austra ERP demo:**

E-mail: [info@zetaindustry.eu](mailto:info@zetaindustry.eu)

Phone: +371 28 326 232

[www.zetaindustry.eu](http://www.zetaindustry.eu)